

Installation raiser set - Segò L

1.

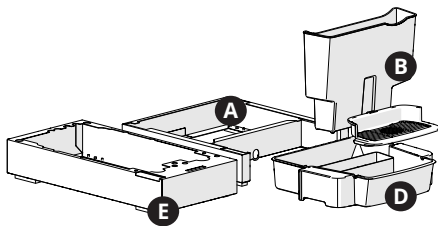

raiser set (7.270.623.101),
if a drainage set is also to be installed, do so first

2.

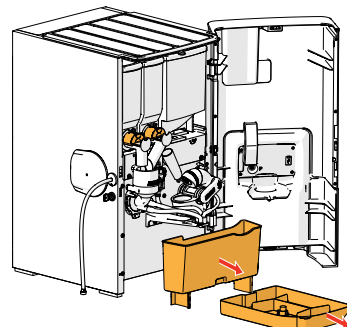

close the canister outlets, remove the drip tray,
waste bin and close the door

3.

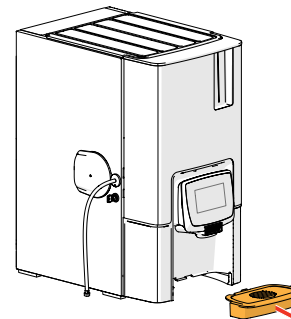

remove the drip tray plate

4.

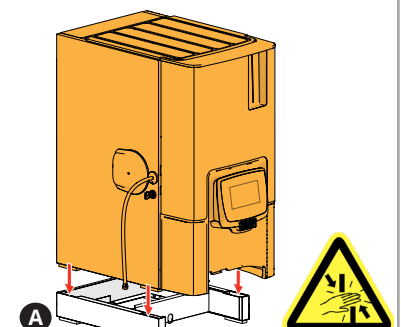

place the Segò L carefully on its raiser set

5.

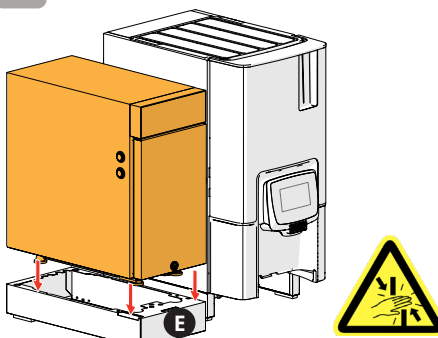

place the Milk fridge carefully on its raiser set

6.

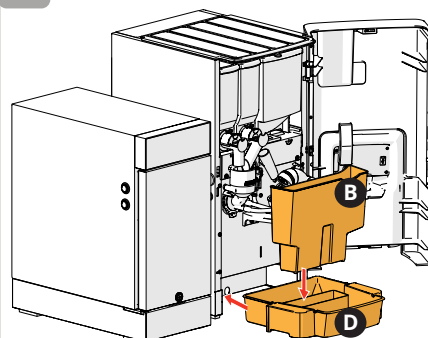

place the new drip tray and waste bin

7.

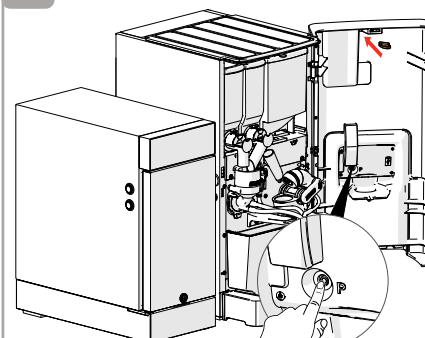

place the safety key and
press the P(rogramming) button

8.

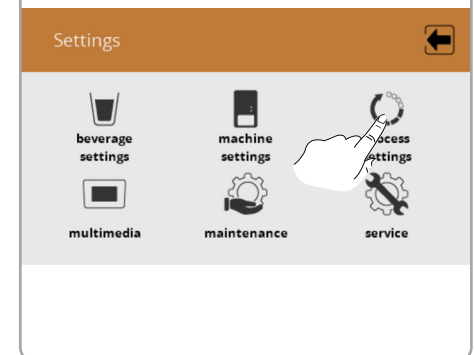

9.

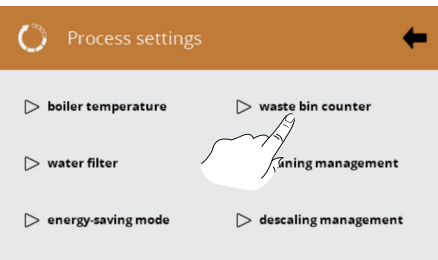

10.

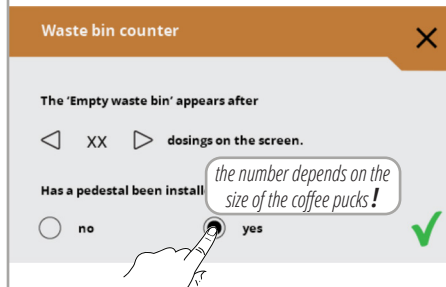

confirm your change, close the programming
screen and remove the safety key

	coffee dosing	maximum coffee pucks for waste bin (xx)
STD	7.5 gr	55
US / CA / MX	12 gr	40

11.

